



Vehicle Access Control  
Pedestrian Access Control  
Safety & Security Equipment

T: +61 7 3205 1123

[www.rotech.com.au](http://www.rotech.com.au)

e: [info@rotech.com.au](mailto:info@rotech.com.au)

# SafePass I 20 Wired PE BEAM

## User Manual (V04/22)



# Technical parameters:

Power supply	12/24(VAC/VDC)
Max.Range up	20Meters(indoor or outdoor)
Opera temperature	-10-+60°C
Max.TX working current	25mA
Max. RX working current	35mA
Max. Relay contact	Max 500mA e 48Vac/dc
IP rate	Ip65 with rubber seal

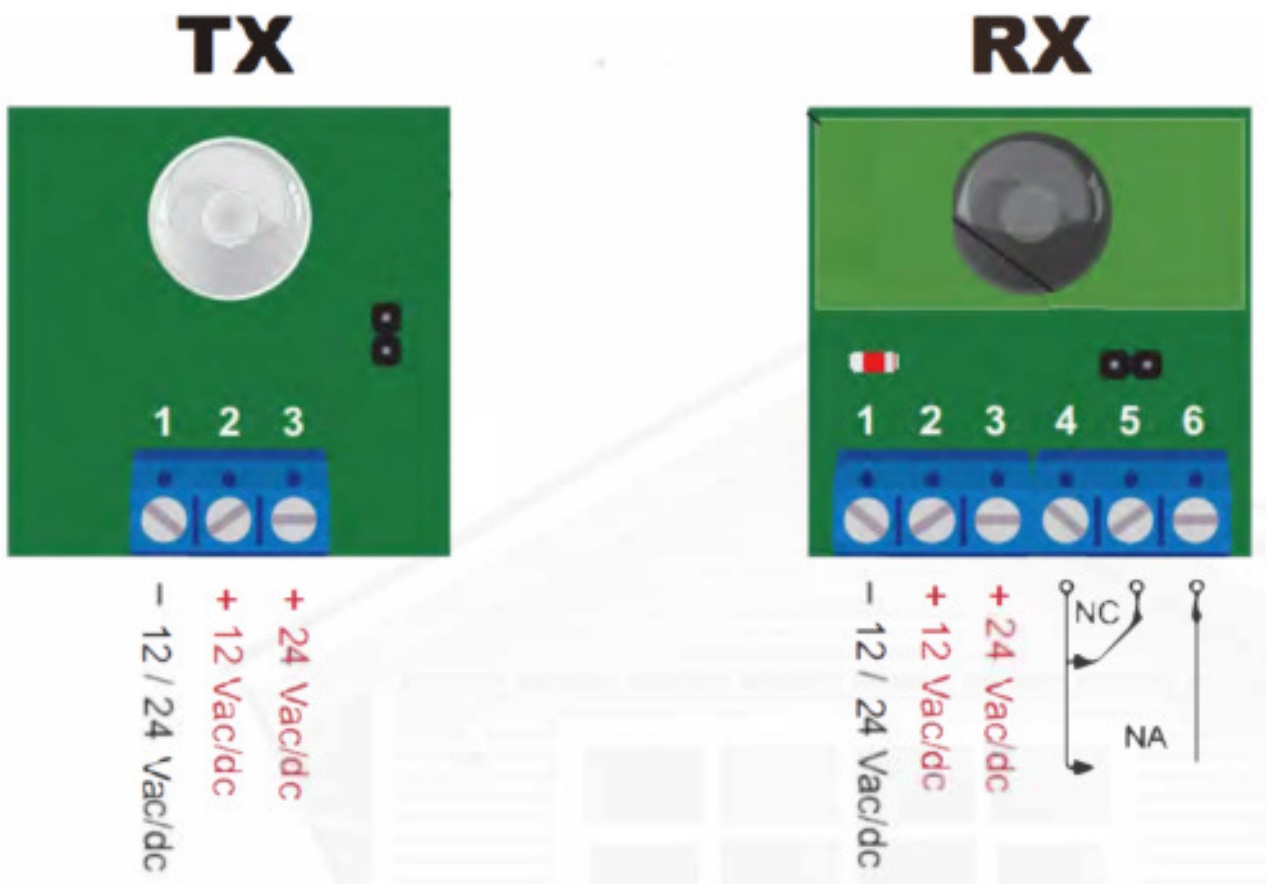

## Dimensions:

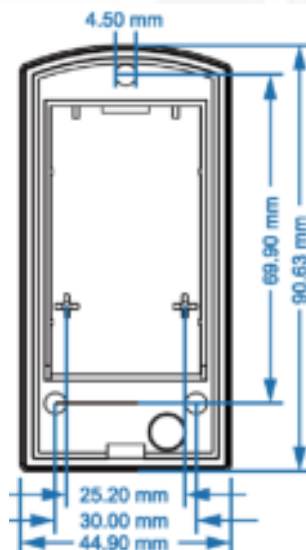

4 = Common  
5 = N.C.  
6 = N.O.

# Installation:

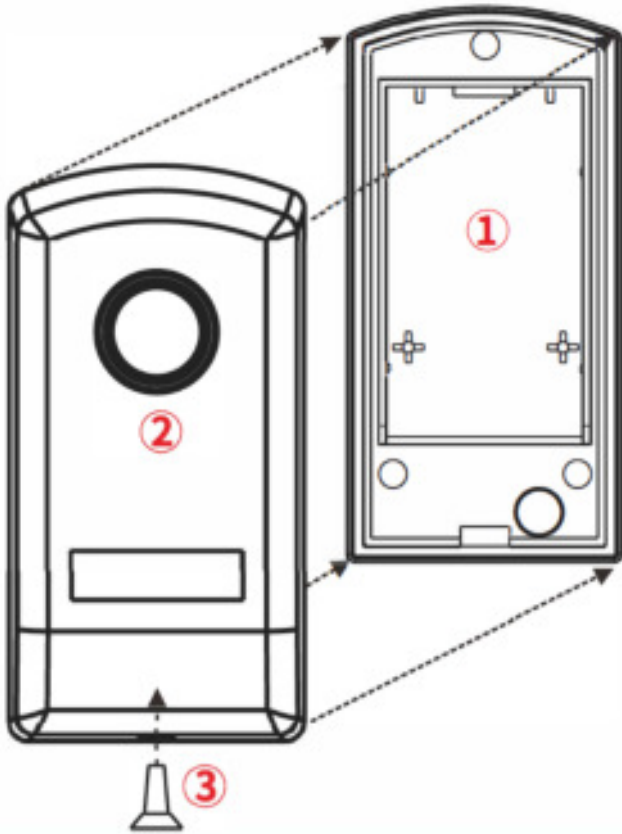

1. To open the I 20, lift the front panel of the photocell. Insert the cables in their housing and fix the base to the wall.

2. If the photocell has to be mounted on a wall, drill the three 5  $\varnothing$  holes and fit suitable screw anchors. If the photocell has to be mounted on metal, drill the three 3  $\varnothing$  holes for fitting with the self-tapping screws.

3. Make the connections. Power the photocells with a voltage between 12 and 24V DC/AC. If positioning, alignment and connection have been carried out properly, the red LED on the receiver will be off. Each time the ray is interrupted, the red LED switches on.

4. Cover the photocell with the front panel. Insert to the stop and close it. Interrupt the ray several times checking the relay response. Fix the front panels with the provided screws.